

HOW TO DISPLAY AN AFFECTED PRIVATE BUILDING NOTICE

If a cladding fire risk has been identified at your building through the Safer Buildings combustible cladding checklist, you are required to display a [Form 42 - Affected Private Building Notice](#).

There are particular ways the notice must be displayed, and you must also submit a [Form 76 - Compliance Notice with photographic evidence](#) to demonstrate to the QBCC that the notice is appropriately displayed.

Here are some tips about how to display it correctly and what the QBCC needs to see in your photographic evidence.

IMAGE 1:

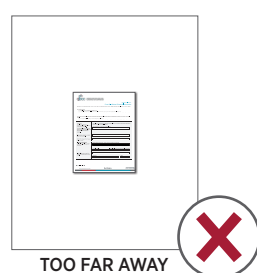
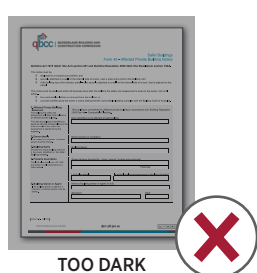
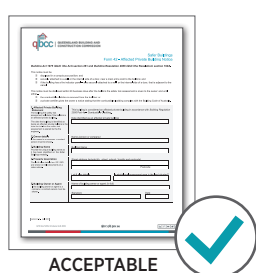

- The first image supplied should be a close-up of the completed, signed and printed Form 42 - Affected Private Building Notice
- The writing on the form must be clearly legible

IMAGE 2:

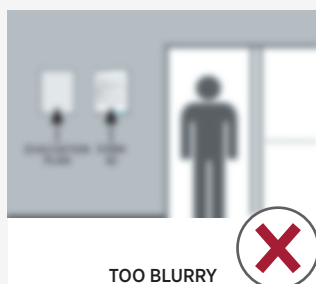
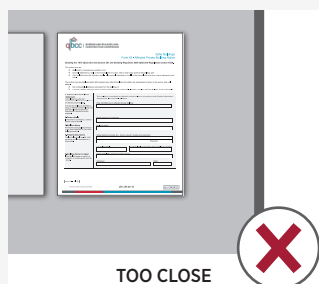
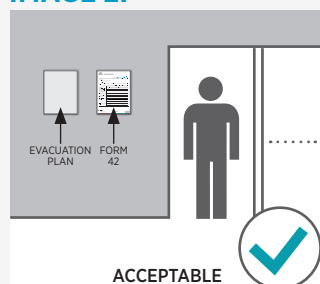

- The second image supplied must be wider to show the area where the notice is displayed
- The notice must be displayed prominently at the entrance and fixed to a wall or door

IMAGE 3:

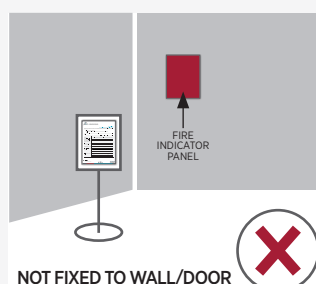
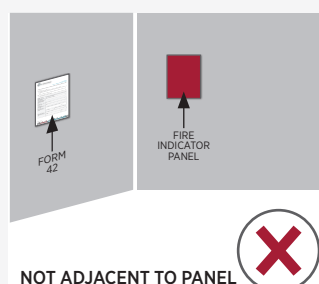
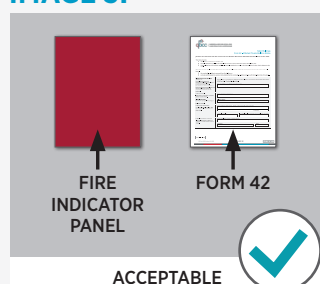

- A third image is required if the building has a fire indicator panel, where a second notice must be displayed
- The notice must be fixed to a wall or door adjacent to the fire indicator panel

OTHER TIPS:

- There is no minimum or maximum size for the image files, however they must be able to be emailed and be a high enough resolution that the image is clear and not blurry.
- Files should be attached to the email to qbcc.saferbuildings@qbcc.qld.gov.au along with the Form 76 - Compliance Notice in a suitable file type. JPG and PNG are preferred.
- Most smart phones will be capable of taking acceptable images.
- The Form 76 - Compliance Notice and photographic evidence must be supplied to the QBCC via email within 5 business days of the Form 42 - Affected Private Building Notice being displayed.